

EASTPORT MUNICIPAL AIRPORT EASTPORT, MAINE

MASTER PLAN UPDATE

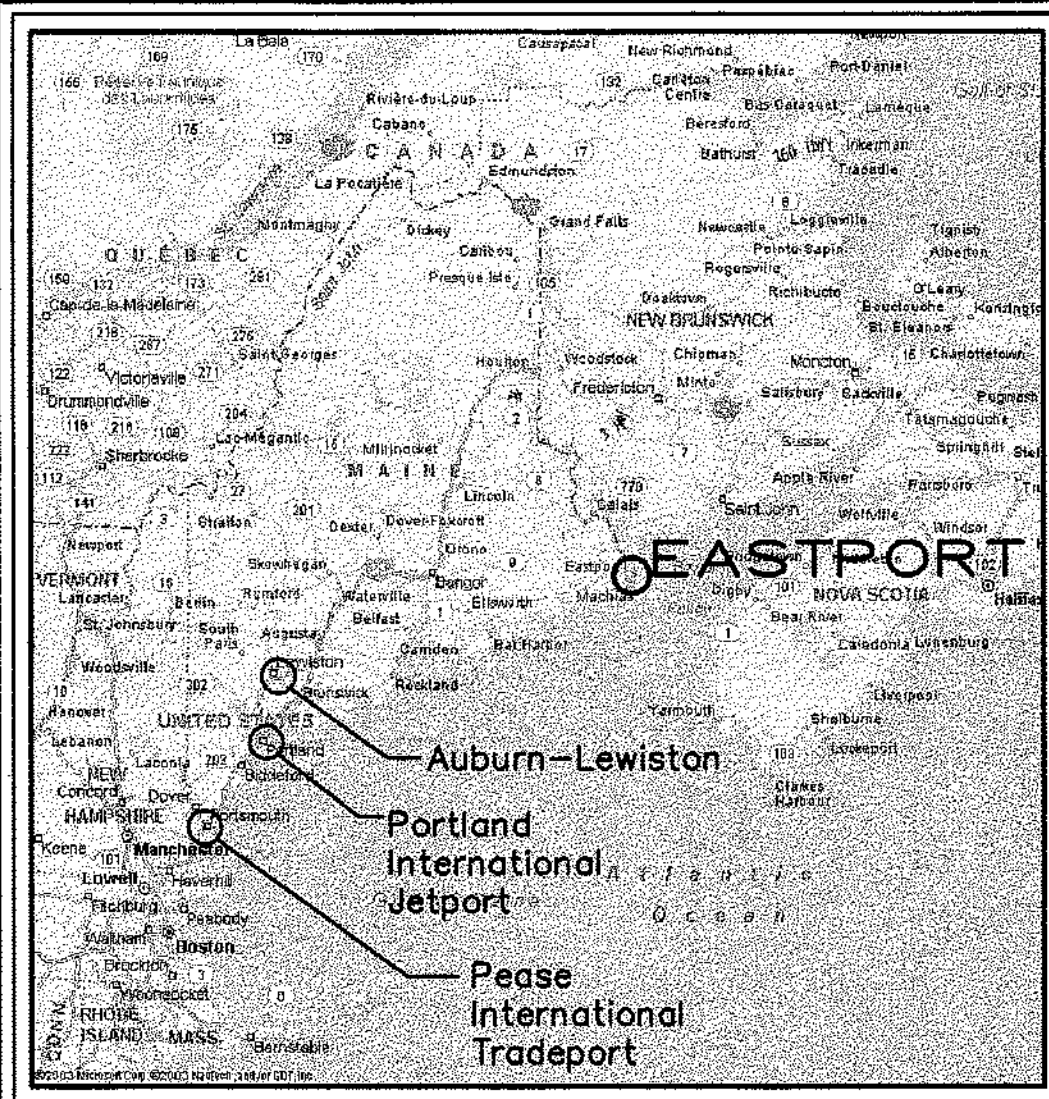

VICINITY MAP
NOT TO SCALE

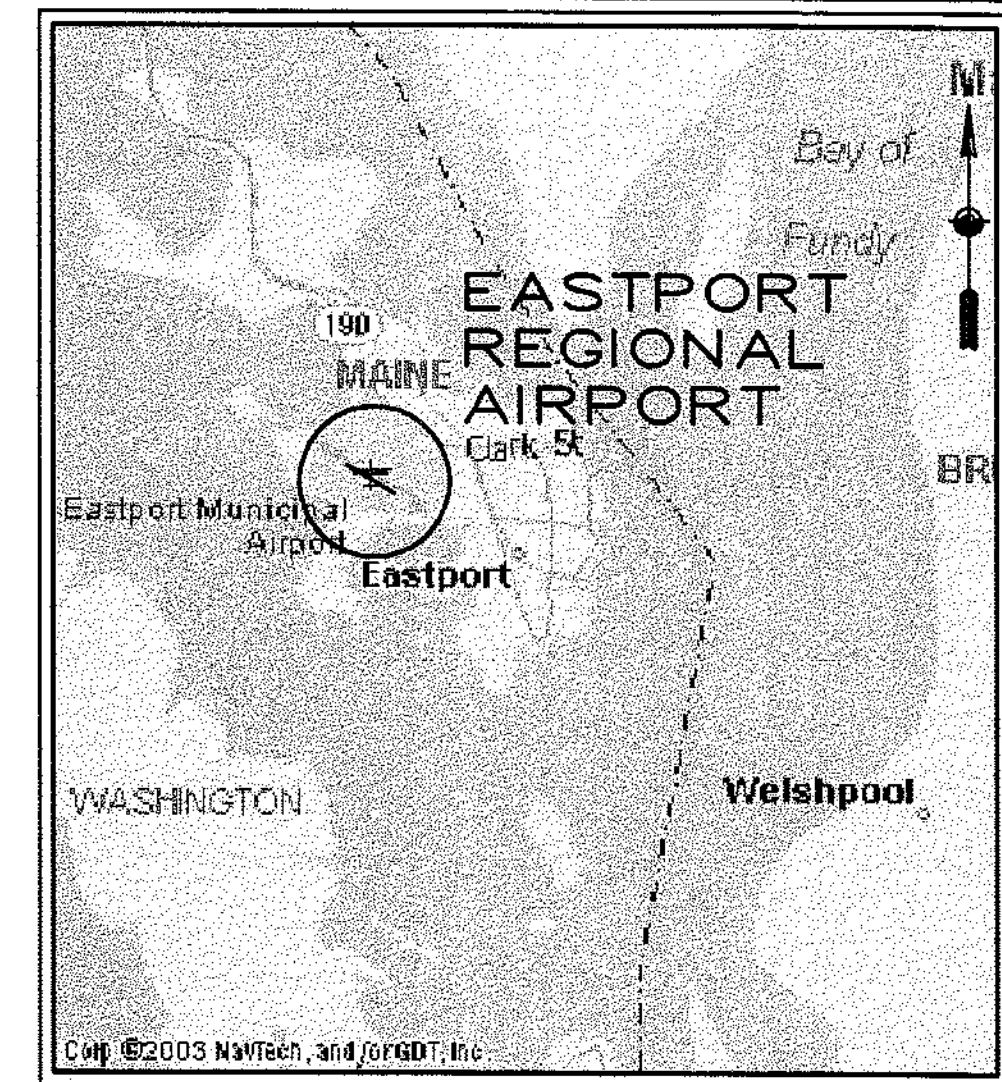

LOCATION MAP
NOT TO SCALE

MAINE DEPARTMENT OF TRANSPORTATION STATE PROJECT NO. SAIP11.1014-02(17) FAA PROJECT NO. AIP3-23-2300-02

INDEX TO DRAWINGS

1. COVER/TITLE SHEET
2. ALP (EXISTING FACILITIES)
3. ALP (ULTIMATE FACILITIES)
4. ALP DATA SHEET
5. TERMINAL AREA PLAN
6. RUNWAY 15-33
PLAN AND PROFILE
7. FAR PART 77 OBJECTS
AFFECTING NAVIGABLE AIRSPACE
8. LAND USE PLAN AND NOISE CONTOUR PLAN

JANUARY, 2004

REV. NO.	DATE	DESCRIPTION

STATE PROJECT NO.	SAIP11.1014-02(17)
PROJECT NO.	EASTPORT
PROJECT NO.	AIP3-23-2300-02

PROJECT DESIGNER	HFA Consulting Engineers
PROJECT DESIGNER	Hoyle, Tanner & Associates, Inc.
150 DOW STREET -- MANCHESTER, NH 03101 -- 1227	
Tel: (603) 669-5555	Fax: (603) 669-4166
www.hta-nh.com	WEB PAGE: www.hta-nh.com
DES. BY	DG
DR. BY	RWH
CHKD. BY	JRL
SCALE:	AS SHOWN
DATE:	JANUARY, 2004

EASTPORT MUNICIPAL AIRPORT AIRPORT MASTER PLAN UPDATE	COVER/TITLE SHEET
--	--------------------------

HTA PROJ. No.: 302902.01
Estcv01.dwg
DRAWING NO.
1
SHEET 1 OF 8

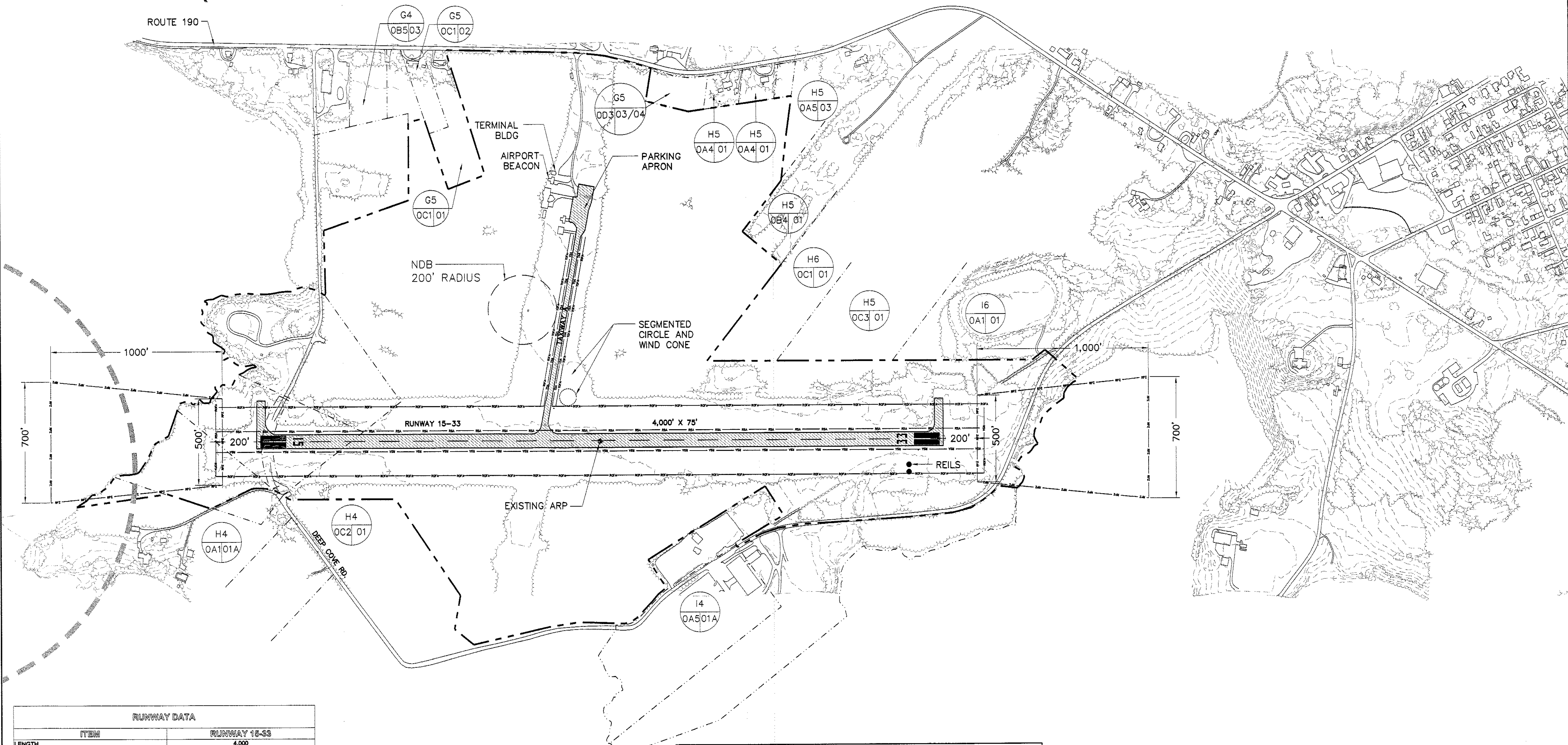
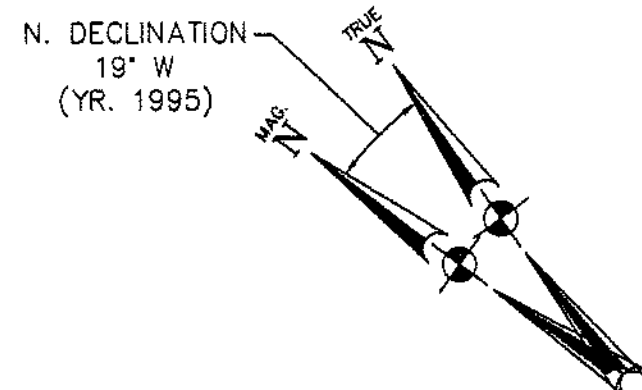

RUNWAY DATA	
ITEM	RUNWAY 15-33
LENGTH	4,000
WIDTH	75'
PAVEMENT STRENGTH	30,000 LBS. SINGLE WHEEL
SURFACE MATERIAL	ASPHALT
EFFECTIVE GRADIENT (%)	RUNWAY 15: (-0.10%) RUNWAY 33: (+0.10%)
CLASSIFICATION/APPROACH CATEGORY	RUNWAY 15: NON-PRECISION RUNWAY 33: NON-PRECISION
APPROACH MINIMUMS (VISIBILITY/CEILING)	RUNWAY 15: DH 438 & VIS. 1 MILE RUNWAY 33: MDA 600 & VIS. 1 MILE
VISUAL/APPROACH AIDS	RUNWAY 15: WINDSOCK; REILS RUNWAY 33: PAPI; WINDSOCK; REILS
NAVIGATIONAL AIDS	RUNWAY 15: GPS/NDB RUNWAY 33: GPS/NDB
RUNWAY LIGHTING	MIRL
RUNWAY MARKING	RUNWAY 15: NON-PRECISION RUNWAY 33: NON-PRECISION
DESIGNATED INSTRUMENT RUNWAY	RUNWAY 33: GPS
CRITICAL AIRCRAFT WING SPAN	38.7
CRITICAL AIRCRAFT APPROACH SPEED	65 KTS
CRITICAL AIRCRAFT MTOW	4750 LBS.
AIRPLANE DESIGN GROUP	I
AIRCRAFT APPROACH CATEGORY	B
PARALLEL TAXIWAY	NONE
TAXIWAY LIGHTING	NONE

AIRPORT DATA	
ITEM	EXISTING
AIRPORT ELEVATION (U.S.G.S. - M.S.L.)	45'
AIRPORT REFERENCE POINT (ARP)	LAT. 44°54'-36.400"N LONG. 67°00'-45.700"W
MEAN MAX TEMPERATURE HOTTEST MONTH	80°F
NAVIGATIONAL AIDS	RUNWAY 15: GPS/NDB & PAPI RUNWAY 33: NDB/GPS
DISTANCE FROM CITY OF EASTPORT	>1 MILE
LAND OWNED (ACRES)/AIRPORT AREA FEE	282
AIRPORT AREA EASEMENTS (ACRES)	1 ACRE
OWNER	CITY OF EASTPORT, MAINE
OPERATIONAL ROLE (NPIAS)	GA
MAG. DECLINATION MAY 30, 1997	18°19'31"48"W
AIRPORT REFERENCE CODE/AIRPORT DESIGN CODE	B-I
WEATHER	AWOS-B

LEGEND			
SYMBOL	DESCRIPTION	SYMBOL	DESCRIPTION
	PAVEMENT EDGE		EAGLE HABITAT PROTECTED AREA
	RUNWAY PAVEMENT EDGE		MAP/BLOCK/LOT NUMBERS FOR PROPERTIES ABUTTING AIRPORT. SEE DATA SHEET (DWG 4) FOR COMPLETE DETAILS.
	RUNWAY CENTERLINE		RUNWAY SAFETY AREA
	EXISTING PAVEMENT		RUNWAY OBJECT FREE AREA
	EXISTING TREE LINE		TAXIWAY SAFETY AREA
	EXISTING CONTOUR (TYP)		TAXIWAY OBJECT FREE AREA
	EXISTING BUILDING		TAXILANE Q TO FIXED OBJECTS
	AIRPORT PROPERTY LINE		RUNWAY VISIBILITY ZONE
	ABUTTING PROPERTY LINES		
	SEGMENTED CIRCLE/WINDSOCK		
	EXISTING TURF TIE DOWN		
	RUNWAY PROTECTION ZONE		

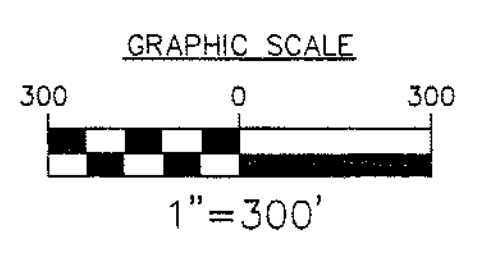

PROJECT DESIGNER: **Hoyle, Tanner & Associates, Inc.**
 150 DOW STREET - MANCHESTER, NH 03101 - 1227
 Tel: (603) 669-5555 Fax: (603) 669-4166 WEB PAGE: www.hta-nh.com
 PROJECT NO.: SA111.1014-02(17)
 STATE PROJECT NO.: SA111.1014-02(17)
 EASTPORT PROJECT NO.: AIP3-23-2300-02
 SCALE: AS SHOWN DATE: AUGUST, 2003
 DES. BY: WPR DR. BY: RWH CHECKED BY: JRL
 HFA Consulting Engineers
 REVISIONS: BY: DESCRIPTION DATE: REV. NO.:

EASTPORT MUNICIPAL AIRPORT
 AIRPORT MASTER PLAN UPDATE
**AIRPORT LAYOUT PLAN
 (EXISTING FACILITIES)**
 HTA PROJ. No.: 302902.01
 EstEALP02.dwg
 DRAWING NO. **2**
 SHEET 2 OF 8

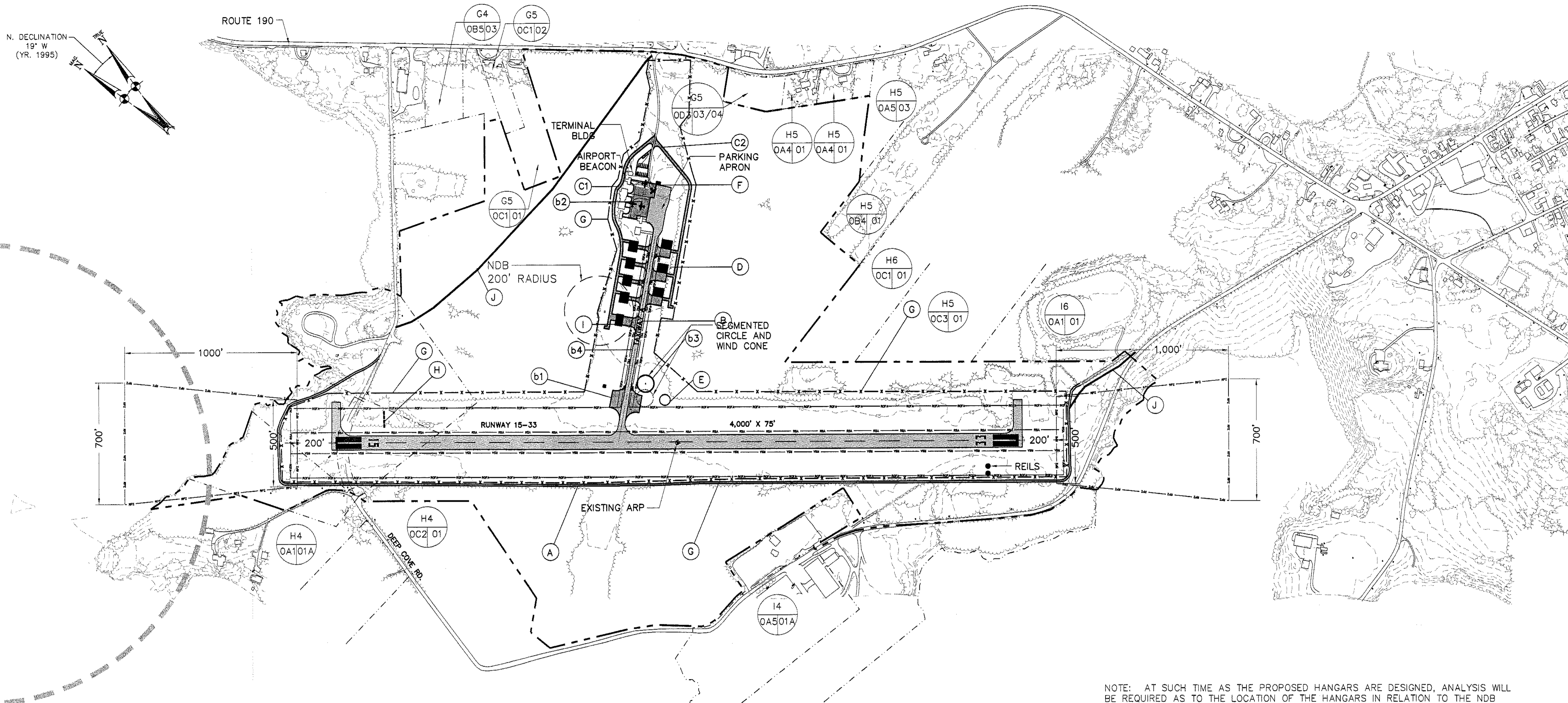
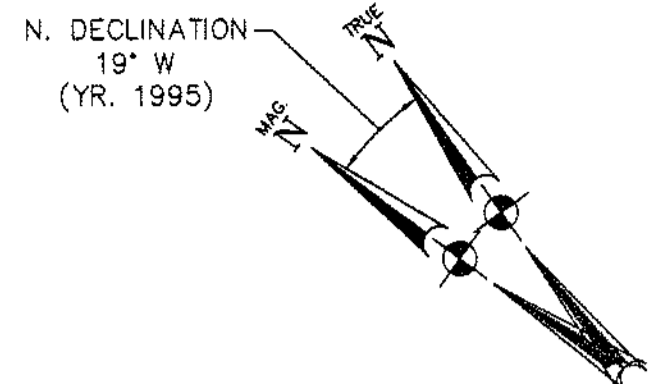

NOTE: AT SUCH TIME AS THE PROPOSED HANGARS ARE DESIGNED, ANALYSIS WILL BE REQUIRED AS TO THE LOCATION OF THE HANGARS IN RELATION TO THE NDB ANTENNA AND ITS 200' RESTRICTED AREA, AS DEFINED BY THE FAA. EITHER THE HANGAR SITES OR THE ANTENNA MAY HAVE TO BE RELOCATED.

AIRPORT DEVELOPMENT	
A	CONSTRUCT SERVICE ROAD
B	TAXIWAY 'A' IMPROVEMENTS:
b1	INSTALL HOLDING BAYS ON N+S SIDE OF TAXIWAY 'A'
b2	EXPAND APRON AT EAST END OF TAXIWAY 'A'
b3	RELOCATE SEGMENTED CIRCLE
b4	INSTALL TAXIWAY REFLECTORS
C	HANGAR ACCESS ROADS
c1	CONSTRUCT NORTH ACCESS ROAD TO HANGARS (PHASE I)
c2	CONSTRUCT SOUTH ACCESS ROAD TO HANGARS (PHASE II)
D	DESIGNATE LOTS FOR DEVELOPMENT OF INDIVIDUAL HANGARS
E	AUTOMATED SURFACE OBSERVING SYSTEM (ASOS)
F	INSTALL 10,000 GALLON SELF-FUELING FACILITY
G	CONSTRUCT WILDLIFE/SECURITY FENCING AROUND RUNWAY 15-33 & TAXIWAY 'A'
H	INSTALL PAPI RUNWAY 15 END
I	CONSTRUCT SNOW REMOVAL EQUIPMENT BUILDING

AIRPORT DATA		
ITEM	EXISTING	ULTIMATE
AIRPORT ELEVATION (U.S.G.S. - M.S.L.)	45'	SAME
AIRPORT REFERENCE POINT (ARP)	LAT. 44°54'38.400"N LONG. 67°00'45.700"W	SAME
MEAN MAX TEMPERATURE HOTTEST MONTH	80°F	SAME
NAVIGATIONAL AIDS	RUNWAY 15: GPS/NDB RUNWAY 33: NDB/GPS/PAPI	RUNWAY 15 PAPI/GPS/NDB SAME
DISTANCE FROM CITY OF EASTPORT	>1 MILE	SAME
LAND OWNED (ACRES)/AIRPORT AREA FEE	252	SAME
AIRPORT AREA EASEMENTS (ACRES)	1 ACRE	SAME
OWNER	CITY OF EASTPORT, MAINE	SAME
OPERATIONAL ROLE (NPIAS)	GA	SAME
MAG. DECLINATION MAY 30, 1997	19°15'31"48"W	SAME
AIRPORT REFERENCE CODE/AIRPORT DESIGN CODE	B-1	SAME

LEGEND			
SYMBOL	DESCRIPTION	SYMBOL	DESCRIPTION
T	EXISTING TIE-DOWN	(Dashed circle)	EAGLE HABITAT PROTECTED AREA
T	PROPOSED TIE-DOWN	(Map/Block/Lot numbers)	MAP/BLOCK/LOT NUMBERS FOR PROPERTIES ABUTTING AIRPORT. SEE DATA SHEET (DWG 4) FOR COMPLETE DETAILS.
(Dashed line)	PROPOSED PAVEMENT	(Dashed line)	EXISTING BUILDING
(Dashed line)	EXISTING PAVEMENT	(Dashed line)	PROPOSED BUILDING
(Dashed line)	EXISTING TREE LINE	(Dashed line)	AIRPORT PROPERTY LINE
(Dashed line)	EXISTING CONTOUR (TYP)	(Dashed line)	ABUTTING PROPERTY LINES
(Dashed line)	EXISTING BUILDING	(Dashed line)	SEGMENTED CIRCLE/WINDSOCK
(Dashed line)	PROPOSED BUILDING	(Dashed line)	RUNWAY PROTECTION ZONE
(Dashed line)	AIRPORT PROPERTY LINE	(Dashed line)	
(Dashed line)	ABUTTING PROPERTY LINES	(Dashed line)	
(Dashed line)	SEGMENTED CIRCLE/WINDSOCK	(Dashed line)	
(Dashed line)	RUNWAY PROTECTION ZONE	(Dashed line)	

NON CONFORMING CONDITIONS	
DESCRIPTION	
OFF-AIRPORT OBSTRUCTIONS EXEMPT FROM CLEARING PER FAA NEW ENGLAND REGION WAIVER OF AIRPORT STANDARDS, 91-ANE-06-NRA, FEBRUARY 8, 1991	

FEDERAL AVIATION ADMINISTRATION NEW ENGLAND REGION AIRPORTS DIVISION	MAINE DEPARTMENT OF TRANSPORTATION OFFICE OF PASSENGER TRANSPORTATION	CITY OF EASTPORT
APPROVED: <i>[Signature]</i>	APPROVED: <i>[Signature]</i>	APPROVED: <i>[Signature]</i>
DATE: 7-30-2007	DATE: 5-23-07	DATE: 7/19/07

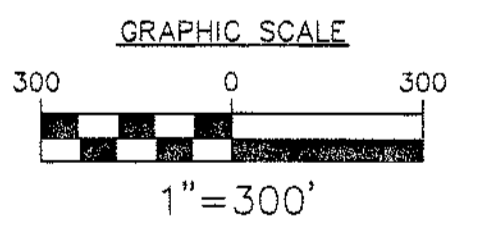

PROJECT DESIGNER
Hoyle, Tanner & Associates, Inc.
150 DOW STREET - MANCHESTER, NH 03101 - 1227
Tel: (603) 669-5555 Fax: (603) 669-4168 Web Page: www.hta-nh.com

PROJECT NO. SA111.1014-02(17)
EASTPORT PROJECT NO. AIP3-23-2300-02

SCALE: AS SHOWN DATE: AUGUST, 2003

DR. BY: RWH
DES. BY: TJA
CHKD. BY: JRL

REVISIONS

REV. NO.	DATE	BY	DESCRIPTION

EASTPORT MUNICIPAL AIRPORT
AIRPORT MASTER PLAN UPDATE

**AIRPORT LAYOUT PLAN
(ULTIMATE FACILITIES)**

HTA PROJ. No.: 302902.01
Est/PALP03.dwg

DRAWING NO. **3**

SHEET 3 OF 8

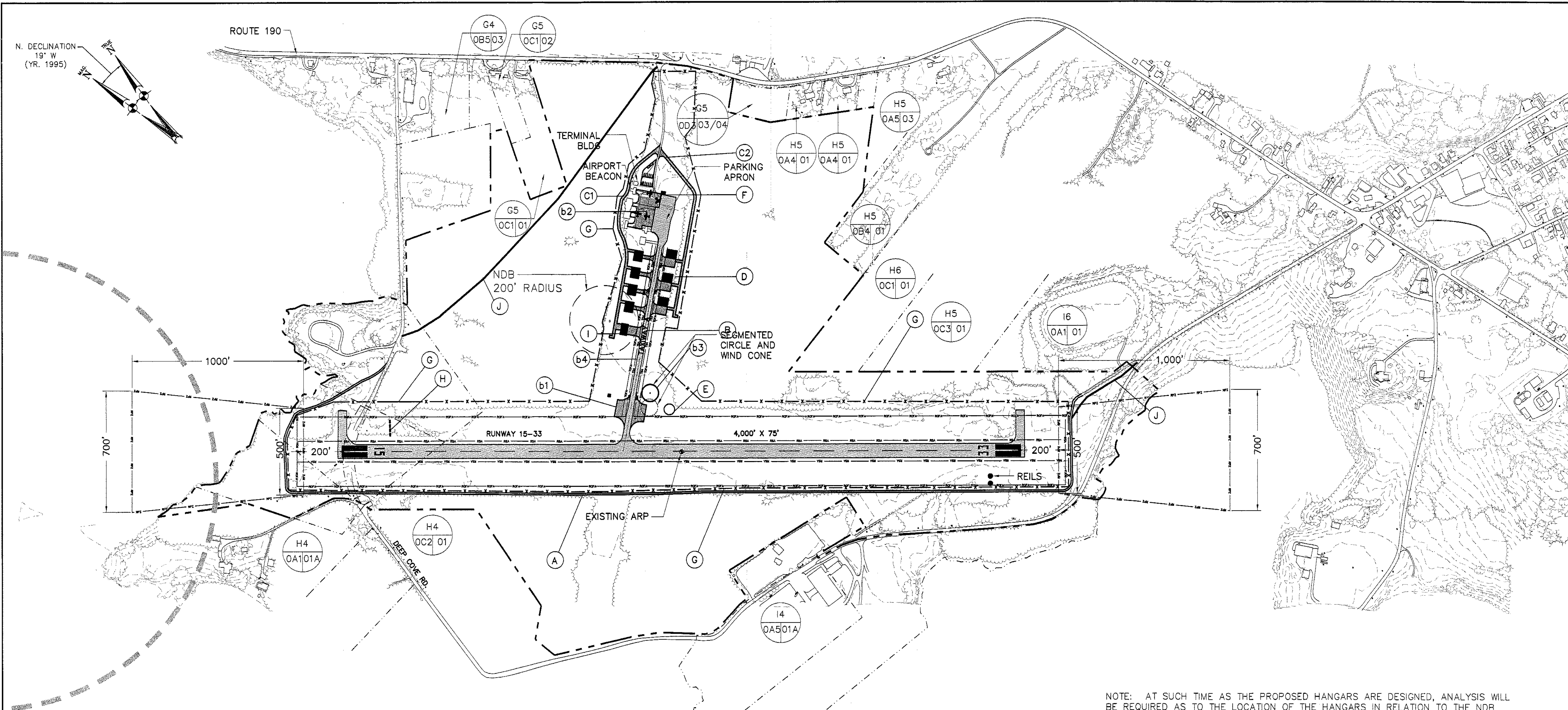

NOTE: AT SUCH TIME AS THE PROPOSED HANGARS ARE DESIGNED, ANALYSIS WILL BE REQUIRED AS TO THE LOCATION OF THE HANGARS IN RELATION TO THE NDB ANTENNA AND ITS 200' RESTRICTED AREA, AS DEFINED BY THE FAA. EITHER THE HANGAR SITES OR THE ANTENNA MAY HAVE TO BE RELOCATED.

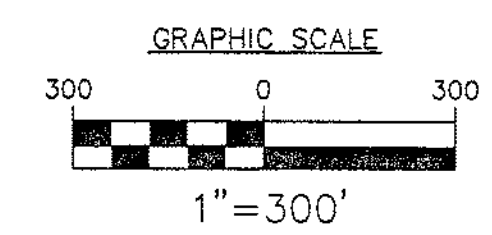

AIRPORT DEVELOPMENT	
A	CONSTRUCT SERVICE ROAD
B	TAXIWAY 'A' IMPROVEMENTS:
b1	INSTALL HOLDING BAYS ON N+S SIDE OF TAXIWAY 'A'
b2	EXPAND APRON AT EAST END OF TAXIWAY 'A'
b3	RELOCATE SEGMENTED CIRCLE
b4	INSTALL TAXIWAY REFLECTORS
C	HANGAR ACCESS ROADS
G1	CONSTRUCT NORTH ACCESS ROAD TO HANGARS (PHASE I)
G2	CONSTRUCT SOUTH ACCESS ROAD TO HANGARS (PHASE II)
D	DESIGNATE LOTS FOR DEVELOPMENT OF INDIVIDUAL HANGARS
R	AUTOMATED SURFACE OBSERVING SYSTEM (ASOS)
F	INSTALL 10,000 GALLON SELF-FUELING FACILITY
Q	CONSTRUCT WILDLIFE/ SECURITY FENCING AROUND RUNWAY 15-33 & TAXIWAY 'A'
H	INSTALL PAPI RUNWAY 15 END
I	CONSTRUCT SNOW REMOVAL EQUIPMENT BUILDING

AIRPORT DATA		
ITEM	EXISTING	ULTIMATE
AIRPORT ELEVATION (U.S.G.S. - M.S.L.)	45'	SAME
AIRPORT REFERENCE POINT (ARP)	LAT. 44°54'35.400"N LONG. 67°00'46.700"W	SAME
MEAN MAX TEMPERATURE HOTTEST MONTH	80°F	SAME
NAVIGATIONAL AIDS	RUNWAY 15: GPS/NDB RUNWAY 33: NDB/GPS/PAPI	RUNWAY 15: PAPI/GPS/NDB SAME
DISTANCE FROM CITY OF EASTPORT	>1 MILE	SAME
LAND OWNED (ACRES)/AIRPORT AREA FEE	252	SAME
AIRPORT AREA EASEMENTS (ACRES)	1 ACRE	SAME
OWNER	CITY OF EASTPORT, MAINE	SAME
OPERATIONAL ROLE (NPIAS)	GA	SAME
MAG. DECLINATION MAY 30, 1987	16°15'148"W	SAME
AIRPORT REFERENCE CODE/AIRPORT DESIGN CODE	B-1	SAME

LEGEND			
SYMBOL	DESCRIPTION	SYMBOL	DESCRIPTION
—T—	EXISTING TIE-DOWN	○	EAGLE HABITAT PROTECTED AREA
—T—	PROPOSED TIE-DOWN	map#	MAP/BLOCK/LOT NUMBERS FOR PROPERTIES ABUTTING AIRPORT. SEE DATA SHEET (DWG 4) FOR COMPLETE DETAILS.
—	RUNWAY CENTERLINE	blk# lot#	
—	EXISTING PAVEMENT	—RSA—	RUNWAY SAFETY AREA
—	PROPOSED PAVEMENT	—ROFA—	RUNWAY OBJECT FREE AREA
—	EXISTING TREE LINE	—TSA—	TAXIWAY SAFETY AREA
—	EXISTING CONTOUR (TYP)	—TOFA—	TAXIWAY OBJECT FREE AREA TAXILANE Q TO FIXED OBJECTS
—	EXISTING BUILDING	—RVZ—	RUNWAY VISIBILITY ZONE
—	PROPOSED BUILDING		
—	AIRPORT PROPERTY LINE		
—	ABUTTING PROPERTY LINES		
—	SEGMENTED CIRCLE/WINDSOCK		
(SEE CALLOUT)			
Zdb	RUNWAY PROTECTION ZONE		
RP2			

NON CONFORMING CONDITIONS	
DESCRIPTION	
OFF-AIRPORT OBSTRUCTIONS EXEMPT FROM CLEARING PER FAA NEW ENGLAND REGION WAIVER OF AIRPORT STANDARDS, 91-ANE-06-NRA, FEBRUARY 8, 1991	

FEDERAL AVIATION ADMINISTRATION NEW ENGLAND REGION AIRPORTS DIVISION	MAINE DEPARTMENT OF TRANSPORTATION OFFICE OF PASSENGER TRANSPORTATION	CITY OF EASTPORT
APPROVED: _____	APPROVED: _____	APPROVED: _____
DATE: _____	DATE: _____	DATE: _____

PROJECT DESIGNER
Hoyle, Tanner & Associates, Inc.
150 DOW STREET - MANCHESTER, NH 03101 - 1227
Tel: (603) 669-5555 Fax: (603) 669-4188 WEB PAGE: www.hta-nh.com

STATE PROJECT NO. SA1P11-1014-02(17)
EASTPORT PROJECT NO. AIP3-23-2300-02

PROJECT DESCRIPTION
EASTPORT MUNICIPAL AIRPORT
AIRPORT MASTER PLAN UPDATE
AIRPORT LAYOUT PLAN
(ULTIMATE FACILITIES)

SCALE: AS SHOWN DATE: AUGUST, 2003

DR. BY: RWH
DES. BY: TJA
CHKD. BY: JRL

HTA PROJ. No.: 302902.01
EstPALP03.dwg

DRAWING NO. **3**

SHEET 3 OF 8

RUNWAY DATA

ITEM	RUNWAY 15-33	
	EXISTING	ULTIMATE
PHYSICAL LENGTH	4,000	SAME
WIDTH	75'	SAME
PAVEMENT STRENGTH	30,000 LBS. SINGLE WHEEL	SAME
SURFACE MATERIAL	ASPHALT	SAME
EFFECTIVE GRADIENT (%)	RUNWAY 15-33: (0.30%)	SAME
CLASSIFICATION/APPROACH CATEGORY	RUNWAY 15: NON-PRECISION RUNWAY 33: NON-PRECISION	SAME
APPROACH MINIMUMS (CEILING/VISIBILITY)	GPS RUNWAY 15: 500 FT & VIS. 1 MILE NBD OR GPS RUNWAY 33: 600 FT & VIS. 1 MILE	SAME
VISUAL/APPROACH AIDS	RUNWAY 15: WINDSOCK; REIL RUNWAY 33: PAPI; WINDSOCK; REIL	RUNWAY 15: WINDSOCK; REIL; PAPI SAME
NAVIGATIONAL AIDS	RUNWAY 15: GPS AND NDB RUNWAY 33: GPS AND NDB	SAME
RUNWAY LIGHTING	MIRL	SAME
RUNWAY MARKING	RUNWAY 15: NON-PRECISION RUNWAY 33: NON-PRECISION	SAME
DESIGNATED INSTRUMENT RUNWAY	RUNWAY 33: GPS	SAME
CRITICAL AIRCRAFT (WING SPAN)	PA-34-200T	SAME
CRITICAL AIRCRAFT APPROACH SPEED	85 KTS	SAME
CRITICAL AIRCRAFT MTOW	4,750 LBS.	SAME
AIRPLANE DESIGN GROUP	I	SAME
AIRCRAFT APPROACH CATEGORY	B	SAME
PARALLEL TAXIWAY	NONE	SAME
TAXIWAY LIGHTING	NONE	REFLECTORS

NOTES:

FAR PART 77 APPROACH SLOPE DATA

	RUNWAY	APPROACH CATEGORY	APPROACH SLOPE
FUTURE	15	SAME	SAME
	33	SAME	SAME
EXISTING	15	NON-PRECISION	34:1
	33	NON-PRECISION	20:1

NOTES:

AIRPORT DESIGN CRITERIA: BI

DESIGN ELEMENT	RUNWAY 15-33		
	DESIGN CRITERIA (FT)	EXISTING	FUTURE
RUNWAY			
LENGTH	SEE NOTE 1	4,000	SAME
WIDTH	60	75	SAME
RUNWAY SAFETY AREA (RSA)			
WIDTH	120	120	SAME
LENGTH BEYOND RUNWAY END	240	240	SAME
RUNWAY OBJECT FREE ZONE (ROFZ)			
WIDTH	400	400	SAME
LENGTH BEYOND RUNWAY END	200	200	SAME
RUNWAY OBJECT FREE AREA (ROFA)			
WIDTH	400	400	SAME
LENGTH BEYOND RUNWAY END	240	240	SAME
RUNWAY SEPARATION STANDARDS			
RUNWAY CENTERLINE TO TAXIWAY/TAXILANE CENTERLINE	225	N/A	N/A
RUNWAY CENTERLINE TO AIRCRAFT PARKING AREA	200	200	SAME
TAXIWAY/TAXILANE			
TAXIWAY 'A'			
TAXIWAY SAFETY AREA (TSA) WIDTH	49	49	SAME
TAXIWAY OBJECT FREE AREA (TOFA) WIDTH	89	89	SAME
TAXILANE OBJECT FREE AREA WIDTH	79	79	SAME
TAXIWAY/TAXILANE SEPARATION STANDARDS			
TAXIWAY CENTERLINE TO PARALLEL TAXIWAY/TAXILANE CENTERLINE	69	N/A	N/A
TAXIWAY CENTERLINE TO A FIXED OR MOVABLE OBJECT	44.5	44.5	SAME
TAXILANE CENTERLINE TO PARALLEL TAXILANE CENTERLINE	64	64	SAME
TAXILANE CENTERLINE TO A FIXED OR MOVABLE OBJECT	39.5	39.5	SAME

NOTES:
(1) SEE FURTHER DISCUSSION IN THE MASTER PLAN UPDATE REPORT

AIRPORT ABUTTERS

MAP	BLOCK NO.	LOT NO.	OWNER	BOOK/PAGE
G4	B5	3	GLORIA & EDWARD MULLEN	2632/029
G4	C5	1	CITY OF EASTPORT	2284/326
G5	C1	1	ROSEANNE CONLEY	2530/338
G5	C1	2	DIANE HICKS	1922/279
G5	D3	3&4	GARY W. LEE	2450/248
H3	A5	1	ARNE CHRISTIAN ASKJEM	2413/320
H4	A1	1A	ARNE & JUNE ASKJEM	2413/320
H4	C2	1	DAVID L. ORREL	1975/46
H5	A4	1	WASHINGTON ST. BAPTIST CHURCH	1145/46
H5	A4	2	LORETTA VERGE	1189/126
H5	A5	3	JOHN & SUNDAY FRANCIS	2136/100
H5	B4	1	ERNEST & JEANETTE GUAY	1528/143
H5	C3	1	MOOSE ISLAND RACING ASSOC.	2075/179
H6	C1	1	MOOSE ISLAND DEVELOPMENT CO.	2077/286
I4	A5	1A	MOOSE ISLAND MARINE	2333/148
I6	A1	1	MOOSE ISLAND RACING ASSOC.	2075/180

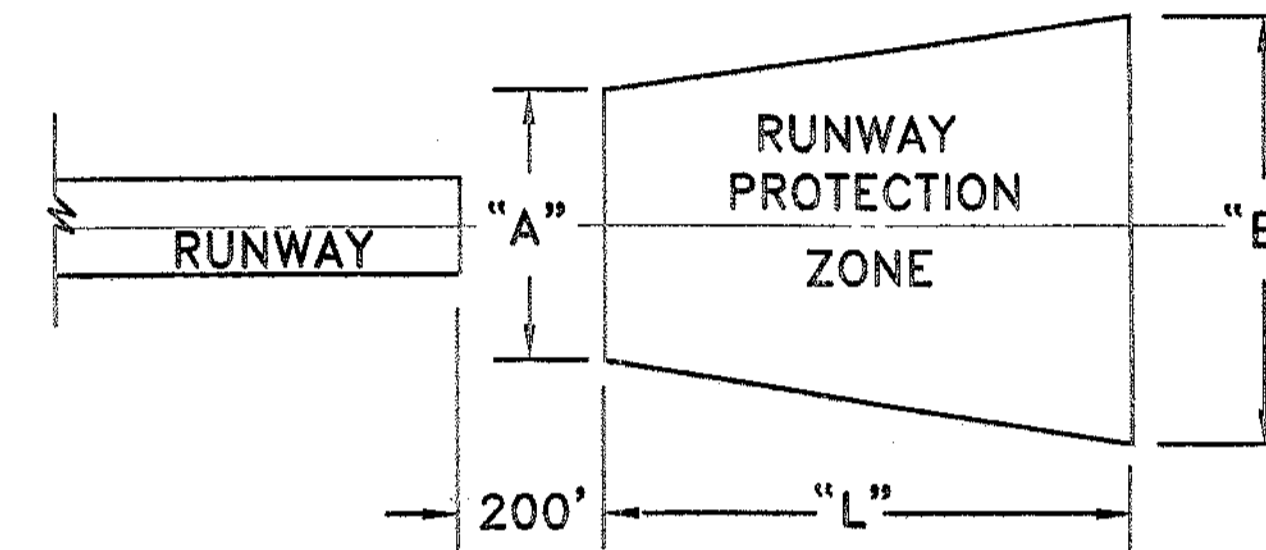

RUNWAY PROTECTION ZONE DATA					
	RUNWAY	APPROACH CATEGORY	"L"	"A"	"B"
FUTURE	15	SAME	SAME	SAME	SAME
	33	SAME	SAME	SAME	SAME
EXISTING	15	NON-PRECISION	1,000	500	700
	33	NON-PRECISION	1,000	500	700

NOTES:

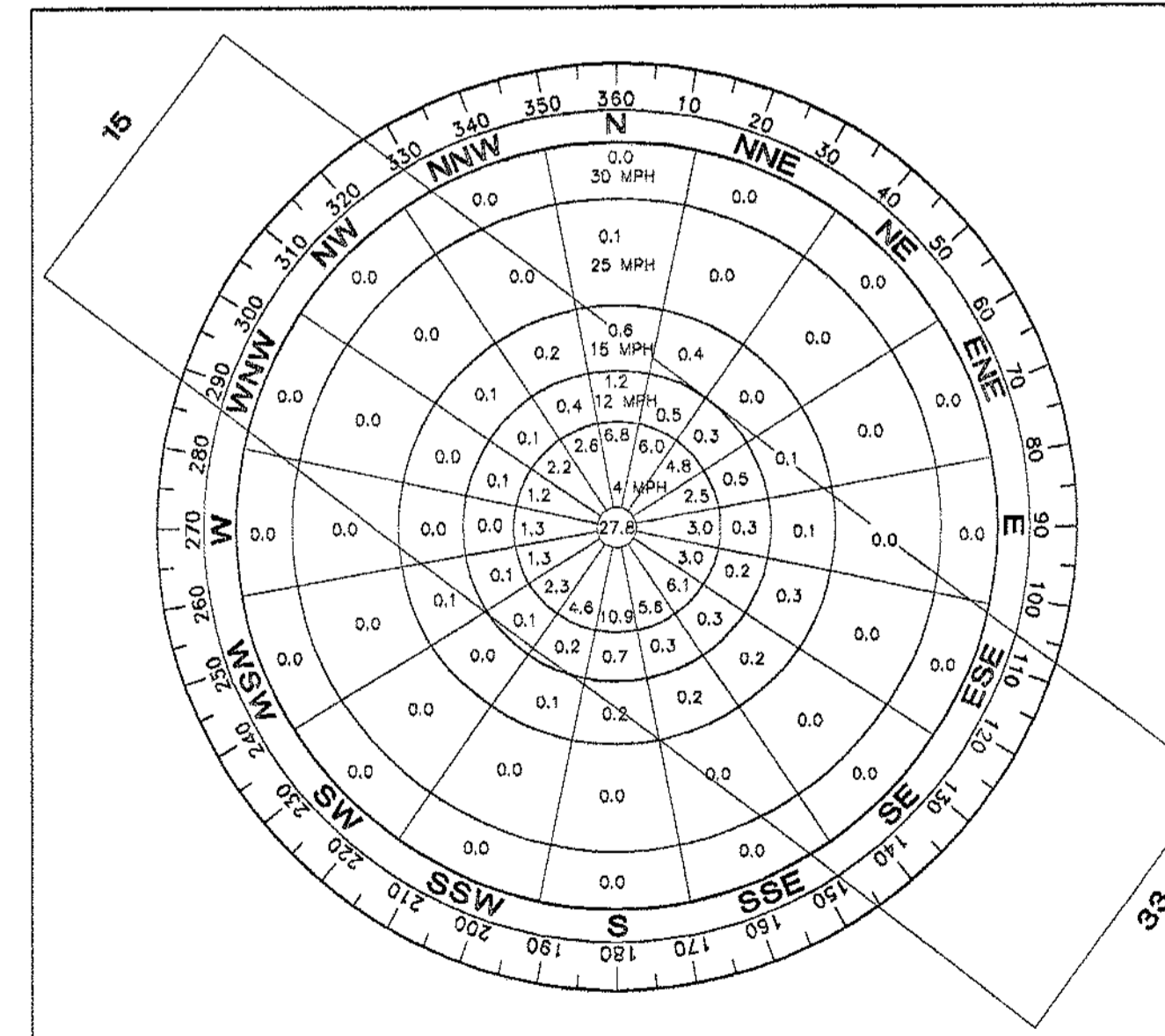

IFR WIND ROSE

CROSSWIND COMPONENT (KNOTS)	RUNWAY 15	RUNWAY 33	TOTAL
13.0	51.0%	40.5%	91.5%

CALMS + 1 - 3 MPH = 27.8% OCCURRENCE: 11.5%
 SOURCE: NATIONAL CLIMATIC CENTER FEDERAL BUILDING ASHEVILLE, NC. DATE: 1960-1964
 STATION: EASTPORT, MAINE
 SOURCE: EASTPORT MASTER PLAN STUDY, OCT 1986

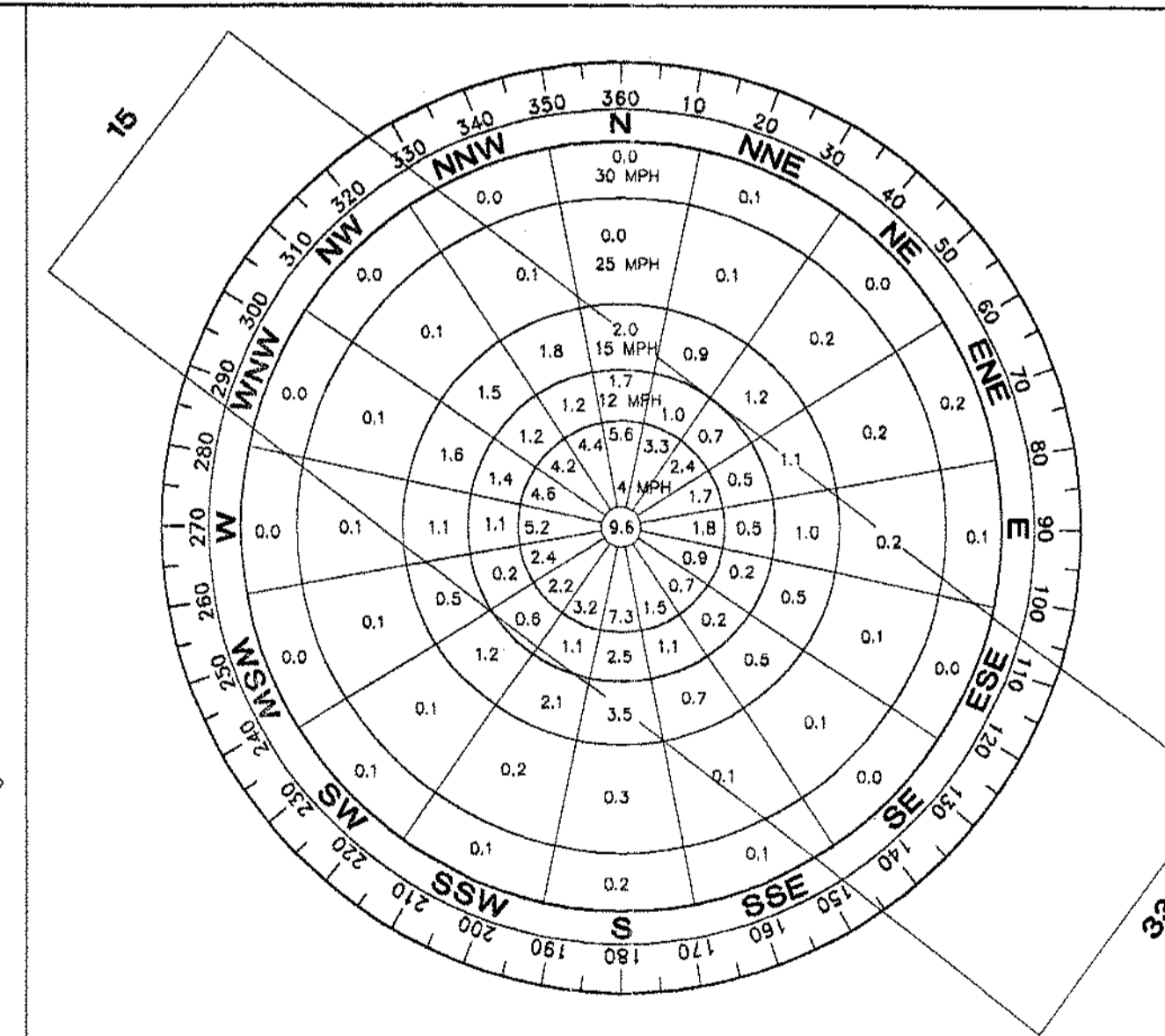

ALL WEATHER WIND ROSE

CROSSWIND COMPONENT (KNOTS)	RUNWAY 15	RUNWAY 33	CALMS	COMBINED
13.0	36.4%	52.4%	9.8%	98.4%

CALMS + 1 - 4 MPH = 9.6% OCCURRENCE: 100%
 SOURCE: STATE OF MAINE DEPT. OF ENVIRONMENTAL PROTECTION BUREAU OF AIR QUALITY CONTROL DATE: 1982-1984 INCLUSIVE
 STATION: EASTPORT, MAINE
 SOURCE: EASTPORT MASTER PLAN STUDY, OCT 1986

REVISIONS BY DESCRIPTION

STATE PROJECT NO. SAP11.1014-02(17)

EASTPORT PROJECT NO. AP3-23-2300-02

HTA Consulting Engineers

PROJECT DESIGNER: Hoyle, Tanner & Associates, Inc.

150 DOW STREET - MANCHESTER, NH 03101 - 1227
 Tel: (603) 669-5555 Fax: (603) 669-4168 WEB PAGE: www.hta-nh.com

SCALE: AS SHOWN DATE: JANUARY, 2004

EASTPORT MUNICIPAL AIRPORT AIRPORT MASTER PLAN UPDATE

ALP DATA SHEET

HTA PROJ. No.: 302902.01
 EstDSHT04.dwg

DRAWING NO. 4

SHEET 4 OF 8

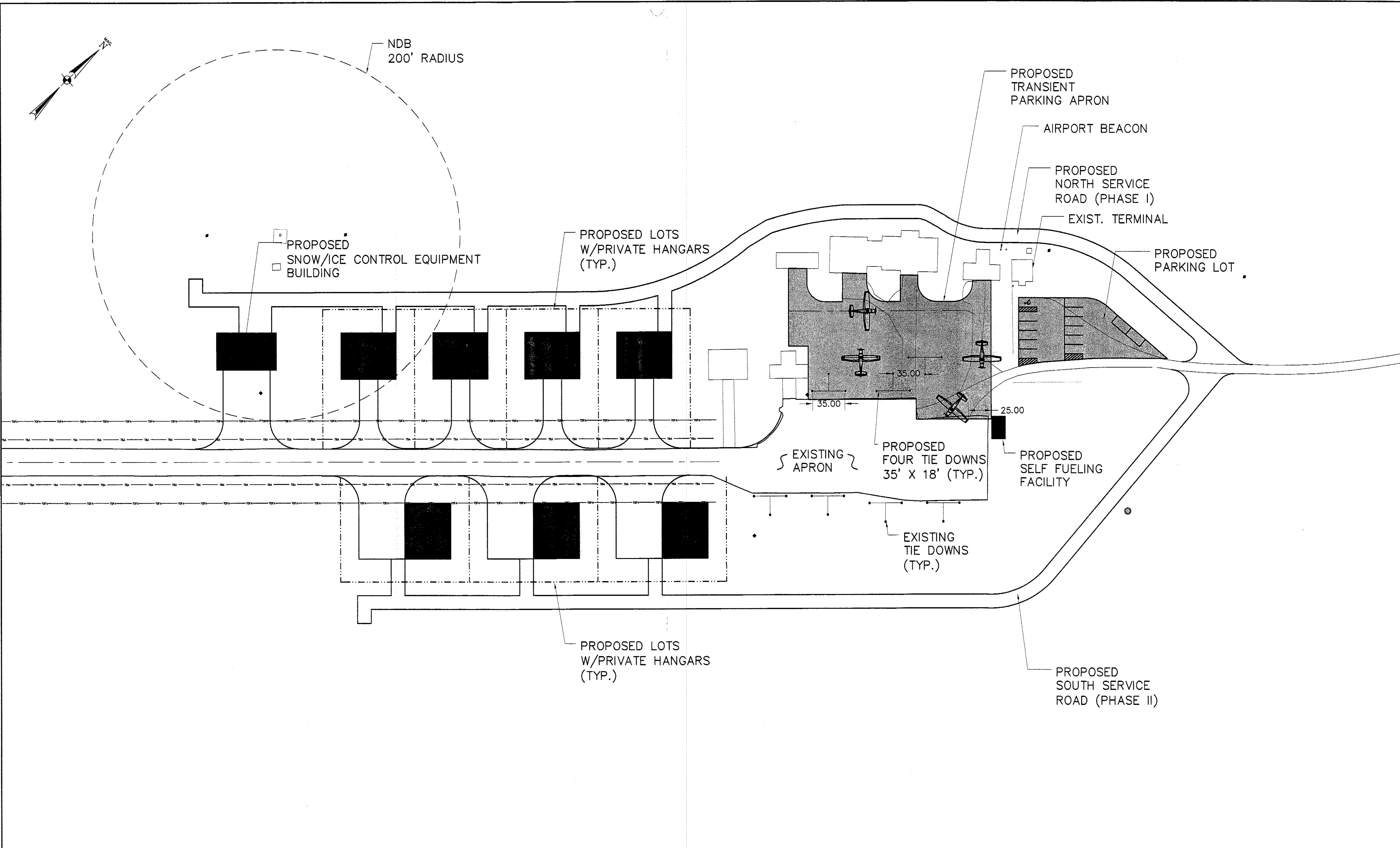

LEGEND			
SYMBOL	DESCRIPTION	SYMBOL	DESCRIPTION
	PAVEMENT EDGE		EXISTING TURF TIE DOWN
	RUNWAY PAVEMENT EDGE		PROPOSED PAVED TIE-DOWN
	TAXIWAY PAVEMENT EDGE		PROPOSED TURF TIE DOWN
	EXISTING PAVEMENT		TSA TAXIWAY SAFETY AREA
	PROPOSED PAVEMENT		TAXIWAY OBJECT FREE AREA
	EXISTING TREE LINE		TAXILANE Q TO FIXED OBJECTS (39.5')
	EXISTING BUILDING		AIRPORT PROPERTY LINE
	PROPOSED BUILDING		

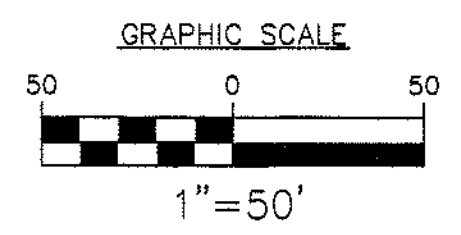

NOTE: AT SUCH TIME AS THE PROPOSED HANGARS ARE DESIGNED, ANALYSIS WILL BE REQUIRED AS TO THE LOCATION OF THE HANGARS IN RELATION TO THE NDB ANTENNA AND ITS 200' RESTRICTED AREA, AS DEFINED BY THE FAA. EITHER THE HANGAR SITES OR THE ANTENNA MAY HAVE TO BE RELOCATED.

STATE PROJECT NO. SAIP11.1014-02(17)		EASTPORT PROJECT NO. AIP3-23-2300-02	
PROJECT DESIGNER Hoyle, Tanner & Associates, Inc. 150 DOW STREET - MANCHESTER, NH 03101-1227 Tel: (603) 689-5555 Fax: (603) 689-4168 WEB PAGE: www.hta-nh.com	DES. BY TJA	DR. BY RWH	CHKD. BY JRL
PROJECT DESCRIPTION EASTPORT MUNICIPAL AIRPORT AIRPORT MASTER PLAN UPDATE		SCALE: AS SHOWN DATE: AUGUST, 2003	
DRAWING NO. 5		SHEET 5 OF 8	

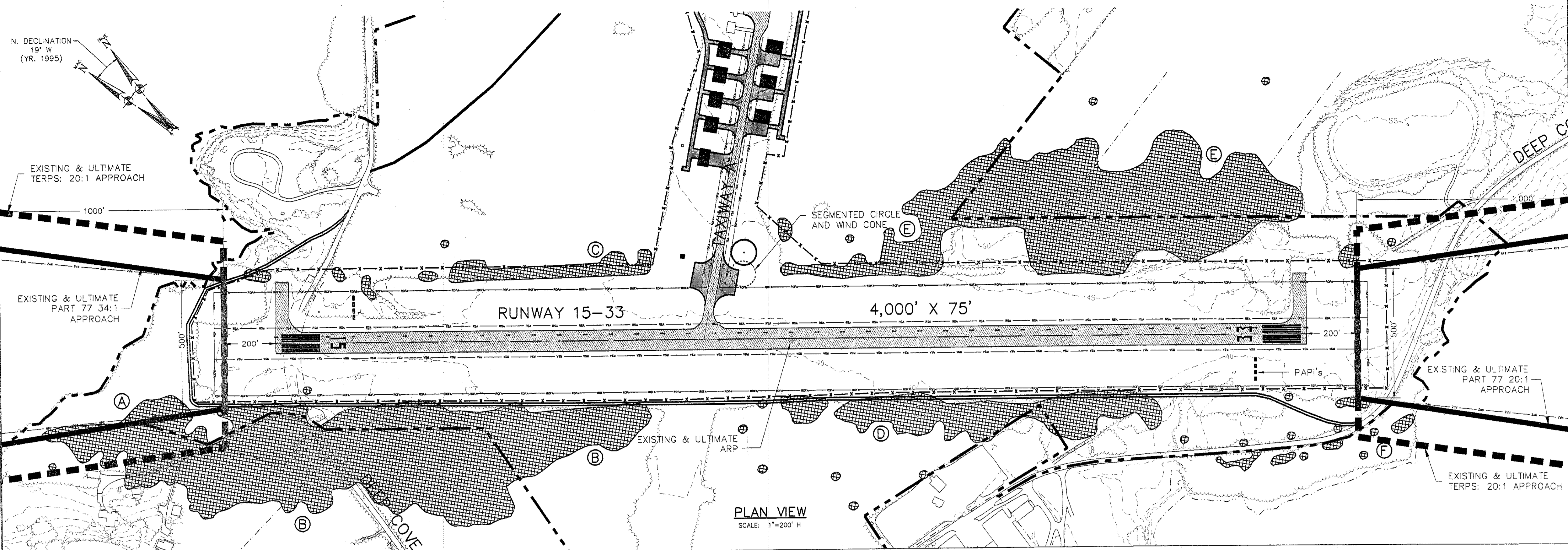

PLAN VIEW
SCALE: 1"=200' H

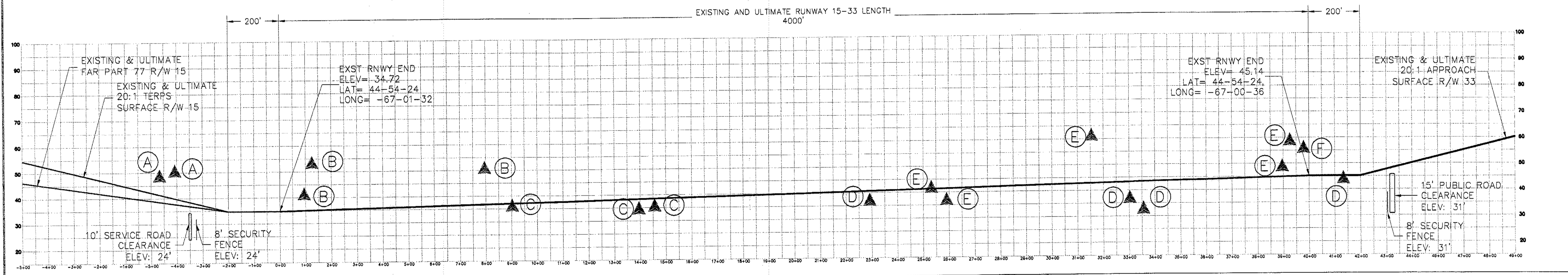

PROFILE
SCALE: 1"=200' H
1"=20' V

LEGEND	
SYMBOL	DESCRIPTION
	PAVEMENT EDGE
	RUNWAY PAVEMENT EDGE
	RUNWAY CENTERLINE
	EXISTING PAVEMENT
	NEW PAVEMENT/DEVELOPMENT
	EXISTING TREE LINE
	EXISTING CONTOUR (TYP)
	PROPOSED BUILDING
	EXISTING BUILDING
	AIRPORT PROPERTY LINE
	ABUTTING PROPERTY LINES
	RUNWAY SAFETY AREA
	RUNWAY OBJECT FREE AREA
	TAXIWAY OBJECT FREE AREA
	TAXIWAY Q TO FIXED OBJECTS
	RUNWAY VISIBILITY ZONE
	SYMBOL FOR PENETRATION SHOWN IN PROFILE. SEE NOTE 3 THIS SHEET.
	SURFACE PENETRATIONS
	EXISTING AVIATION EASEMENT AREA
	SEGMENTED CIRCLE/LIGHTED WINDSOCK
	AIRPORT BEACON
	EXISTING TIE DOWN
	PROPOSED TIE DOWN
	TERPS APPROACH SURFACE
	PART 77 APPROACH SURFACE
	EXISTING & ULTIMATE RUNWAY PROTECTION ZONE

PENETRATION TABLE *	
A	Various penetrations to FAR PART 77 and TERPS APPROACH surfaces on Runway 15, right, offset varies.
B	Penetrations to FAR PART 77 7:1 transition surfaces, Sta. 14+00 to Sta. 13+50 right, offset varies.
C	Penetrations to FAR PART 77 7:1 transition surfaces, Sta. 13+50 to Sta. 23+50 left, offset varies.
D	Penetrations to FAR PART 77 7:1 transition surfaces sta: 22+00 to sta: 44+00 right, offset varies
E	Penetrations to FAR PART 77 7:1 transition surfaces Sta. 24+50 to Sta. 39+00 left, offset varies.
F	Penetrations to TERPS final approach surfaces
*	OFF-AIRPORT OBSTRUCTIONS EXEMPT FROM CLEARING PER FAA NEW ENGLAND REGION WAIVER OF AIRPORT STANDARDS, 91-ANE-06-NRA, FEBRUARY 8, 1991

NOTES:

1. OBSTRUCTIONS SHOWN ARE BY ALPHABETICAL SEQUENCE.
2. OBSTRUCTIONS DATA PROVIDED BY MDOOT-OPT
3. TREE SYMBOLS ARE REPRESENTATIVE OF MULTIPLE OBSTRUCTIONS THAT MAY INCLUDE SHRUBS AND/OR HIGH GROUND.

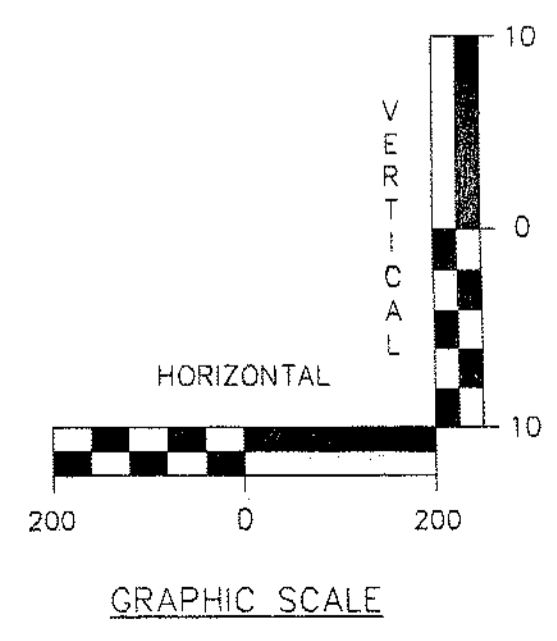

STATE PROJECT NO. SAIP11-1014-02(17)	DATE	REVISIONS
EASTPORT PROJECT NO.		
PROJECT DESIGNER Hoyle, Tanner & Associates, Inc.	DR. BY RWH	CHKD. BY JRL
150 DOW STREET - MANCHESTER, NH 03101 - 1227 Tel: (603) 689-5555 Fax: (603) 689-4168 WEB PAGE: www.hta-nh.com	DES. BY TJA	
EASTPORT MUNICIPAL AIRPORT AIRPORT MASTER PLAN UPDATE	DATE: JANUARY, 2004	SCALE: AS SHOWN
RUNWAY 15-33		
PLAN AND PROFILE		
HTA PROJ. No.: 302902.01 EstPLNPROF06.dwg		
DRAWING NO. 6		
SHEET 6 OF 8		

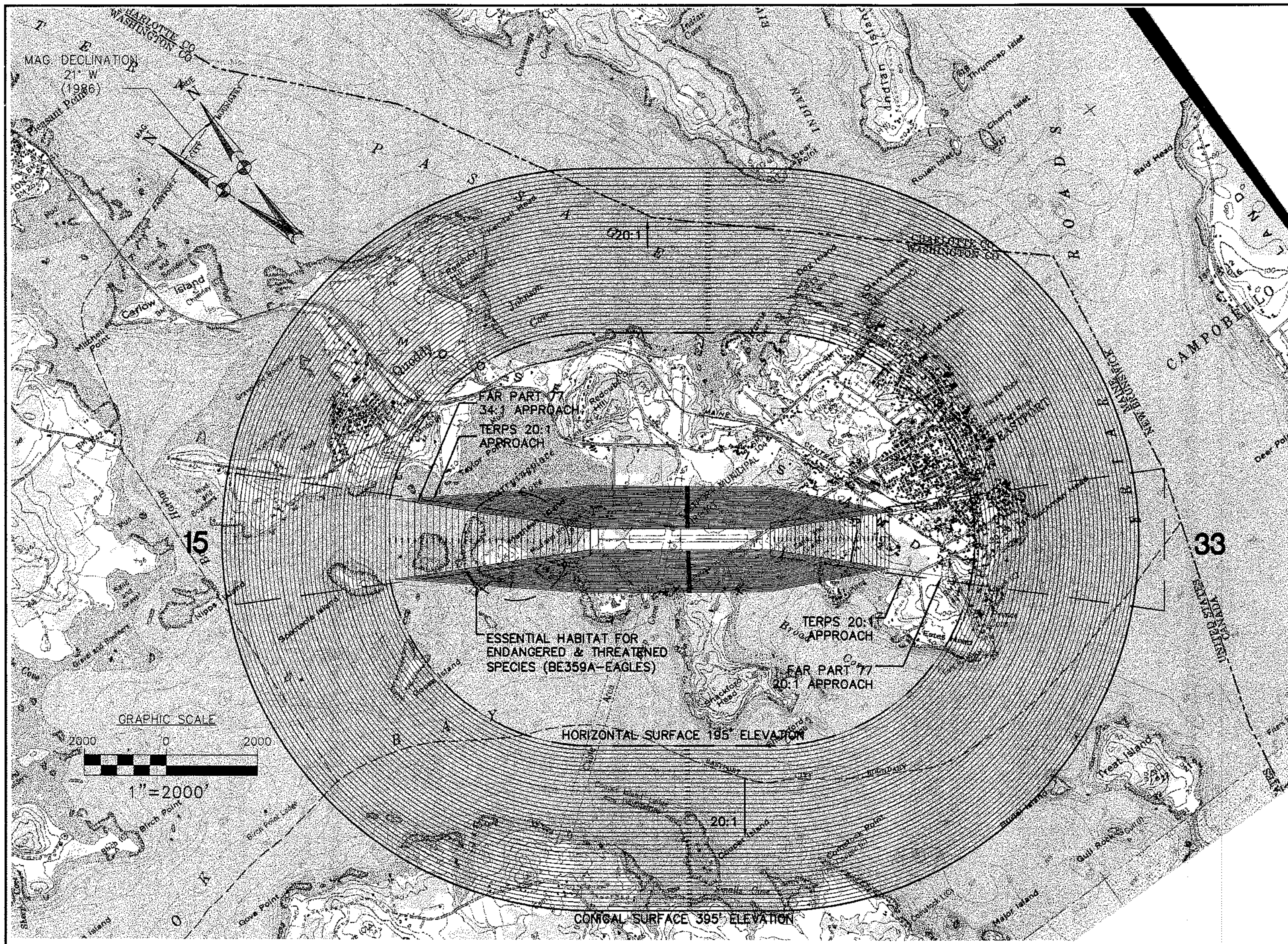

LEGEND

SYMBOL	DESCRIPTION	SYMBOL	DESCRIPTION
—	EXISTING ROADS	- - -	FAR PART 77 APPROACH SURFACE ABOVE HORIZONTAL SURFACE ELEVATION
—	CONICAL SURFACE	—	TERPS APPROACH SURFACE
- - -	HORIZONTAL SURFACE	—	PRIMARY SURFACE
—700—	SURFACE ELEVATION CONTOUR		
○	ESSENTIAL HABITAT PROTECTION AREA (EAGLES NEST)		

Part 77 Objects Affecting Navigable Airspace

Airport Data	Runway 15	Runway 33
Classification	'A' - Utility	'A' - Utility
Approach	Non-precision	Non-precision
Visibility Minimums	1- mile	1- mile
Airport Elevation	45 feet above MSL	
Airport Imaginary Surface	Runway 15	Runway 33
Horizontal Surface:		
Horizontal Surface Elevation	195	
Horizontal Surface Radius	5,000	5,000
Conical Surface:		
Horizontal Distance	4,000	4,000
Slope	34:1	20:1
Primary Surface:		
Length beyond runway end	200	200
Width	500	500
Approach Surface:		
Horizontal Distance	5,000	5,000
Inner Edge Width	500	500
Outer Edge Width	2,000	2,000
Slope	20:1	20:1
Transitional Surfaces:	7:1	7:1
Source:	FAR Part 77, Objects Affecting Navigable Airspace	

Notes:
 1. Dimensions are in feet unless otherwise noted.
 * OFF-AIRPORT OBSTRUCTIONS EXEMPT FROM CLEARING PER FAA NEW ENGLAND REGION WAIVER OF AIRPORT STANDARDS, 91-ANE-06-NRA, FEBRUARY 8, 1991

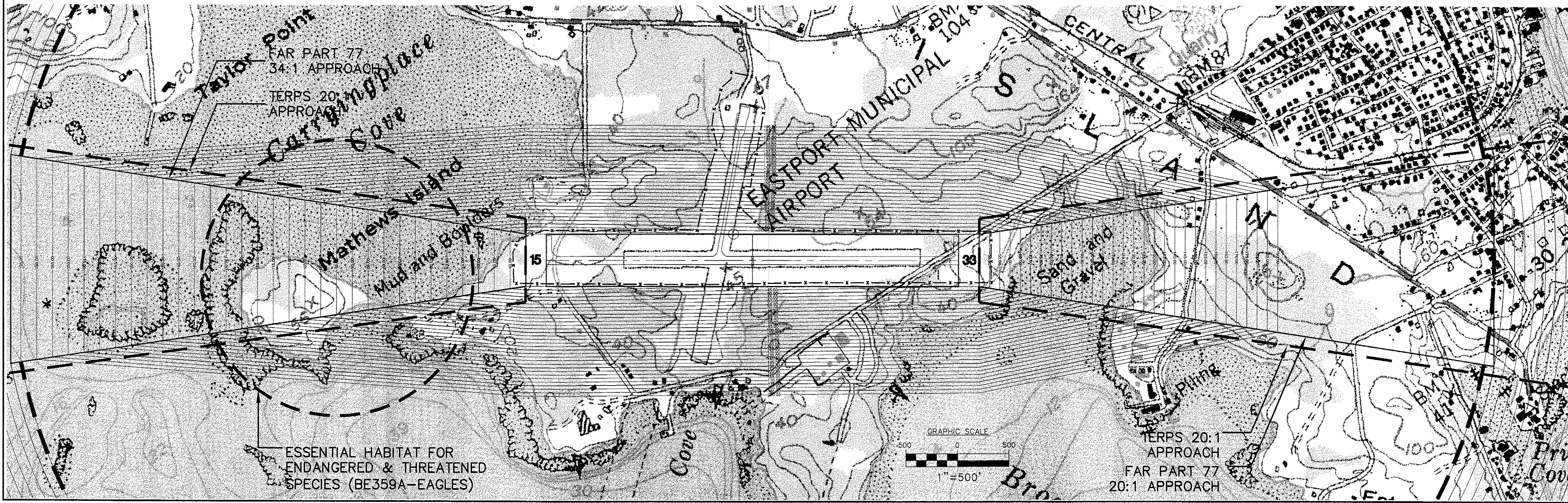

REVISIONS

REV. NO.	DATE	BY	DESCRIPTION
1			

STATE PROJECT NO. SAP11-1014-02(17)

EASTPORT PROJECT NO. AP3-23-2300-02

HTA
Consulting Engineers

PROJECT DESIGNER
Hoyle, Tanner & Associates, Inc.

150 DOW STREET - MANCHESTER, NH 03101 - 1227
Tel: (603) 869-5555 Fax: (603) 869-4168 WEB PAGE: www.hta-nh.com

DR. BY: RWH
DES. BY: DG
DATE: JANUARY, 2004

SCALE: AS SHOWN

EASTPORT MUNICIPAL AIRPORT
AIRPORT MASTER PLAN UPDATE

FAR PART 77 OBJECTS AFFECTING NAVIGABLE AIRSPACE

HTA PROJ. No.: 302902.01
EstPART77.dwg

DRAWING NO. **7**

SHEET 7 OF 8

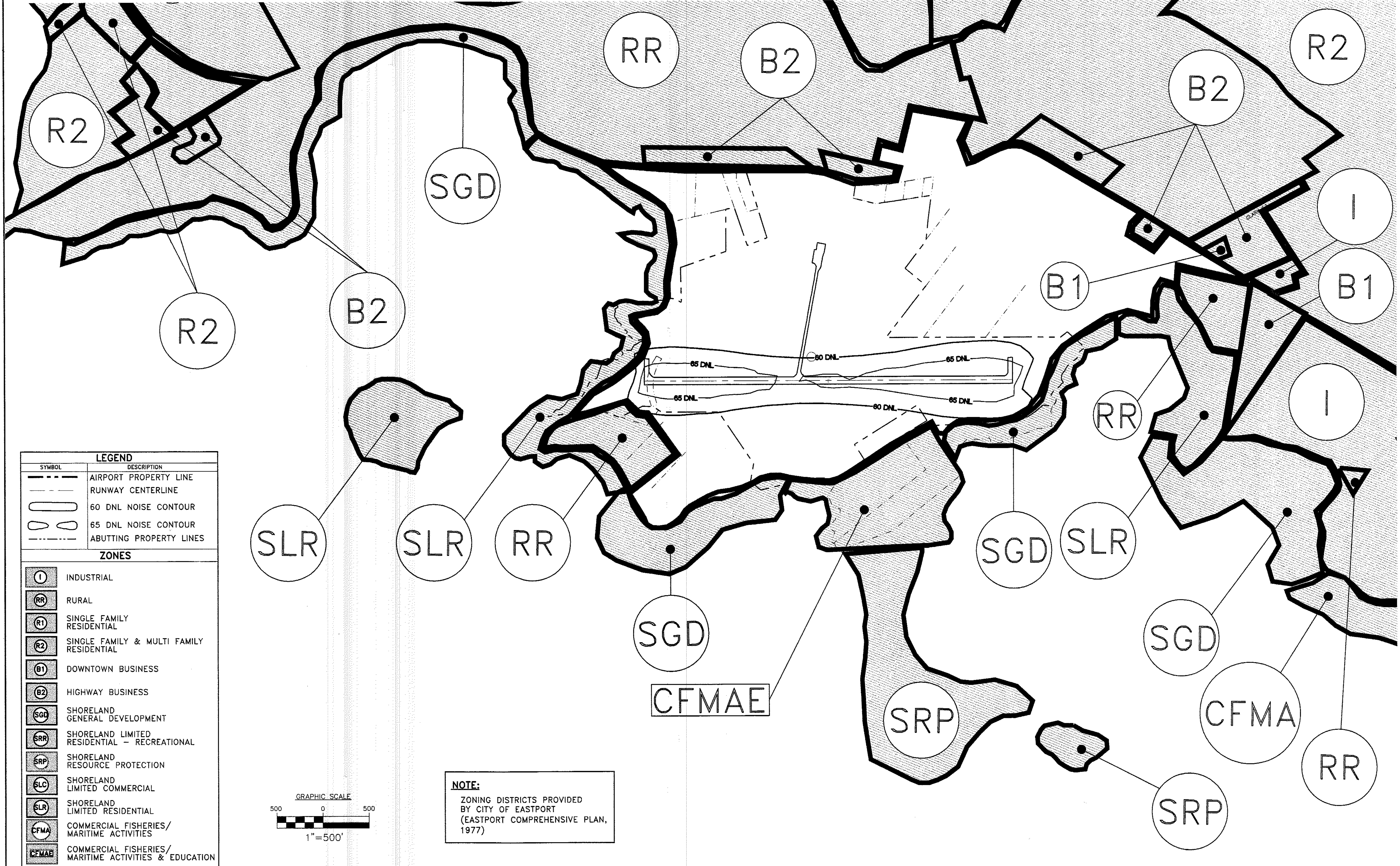
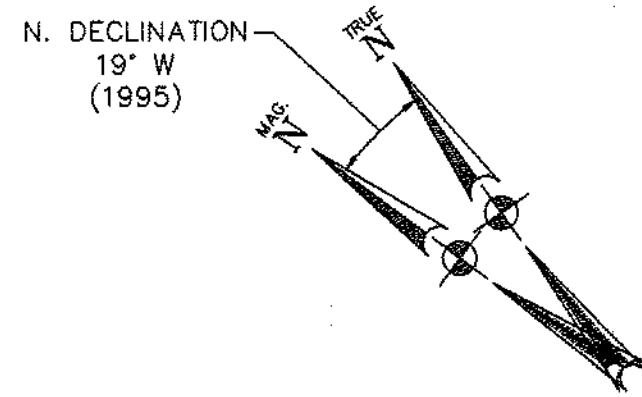

LEGEND	
SYMBOL	DESCRIPTION
--- (dashed line)	AIRPORT PROPERTY LINE
--- (dotted line)	RUNWAY CENTERLINE
--- (solid line)	60 DNL NOISE CONTOUR
--- (solid line)	65 DNL NOISE CONTOUR
--- (dashed line)	ABUTTING PROPERTY LINES
ZONES	
(I)	INDUSTRIAL
(RR)	RURAL
(R1)	SINGLE FAMILY RESIDENTIAL
(R2)	SINGLE FAMILY & MULTI FAMILY RESIDENTIAL
(B1)	DOWNTOWN BUSINESS
(B2)	HIGHWAY BUSINESS
(SGD)	SHORELAND GENERAL DEVELOPMENT
(SRR)	SHORELAND LIMITED RESIDENTIAL - RECREATIONAL
(SRP)	SHORELAND RESOURCE PROTECTION
(SLC)	SHORELAND LIMITED COMMERCIAL
(SLR)	SHORELAND LIMITED RESIDENTIAL
(CFMA)	COMMERCIAL FISHERIES/MARITIME ACTIVITIES
(CFMAE)	COMMERCIAL FISHERIES/MARITIME ACTIVITIES & EDUCATION

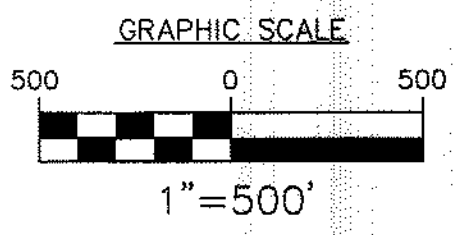

NOTE:
 ZONING DISTRICTS PROVIDED BY CITY OF EASTPORT (EASTPORT COMPREHENSIVE PLAN, 1977)

PROJECT DESIGNER Hoyle, Tanner & Associates, Inc. 150 DOW STREET - MANCHESTER, NH 03101 - 1227 Tel: (603) 689-5555 Fax: (603) 689-4168 WEB PAGE: www.hta-nh.com		STATE PROJECT No. SA111-1014-02(17) EASTPORT PROJECT No. AIP3-23-2300-02
PROJECT No. SA111-1014-02(17)	REVISIONS BY: _____ DATE: _____ REV. NO.: _____	CHKD. BY: JRL DR. BY: RWH DES. BY: DG DATE: JANUARY, 2004 SCALE: AS SHOWN
EASTPORT MUNICIPAL AIRPORT AIRPORT MASTER PLAN UPDATE		LAND USE 8
HTA PROJ. No.: 302902.01 EstLNDUSE08.dwg		SHEET 8 OF 8